

Dec 11, 2020 - 4:05pm F:\Project\301 - Port of Oswego\301.030.002 - REDI GRANTS\301.030.002 - 3RED02 Goble Marina\Design\CADD\Sheet Files\Permitting\301030002\_C-101\_Existing Conditions.dwg

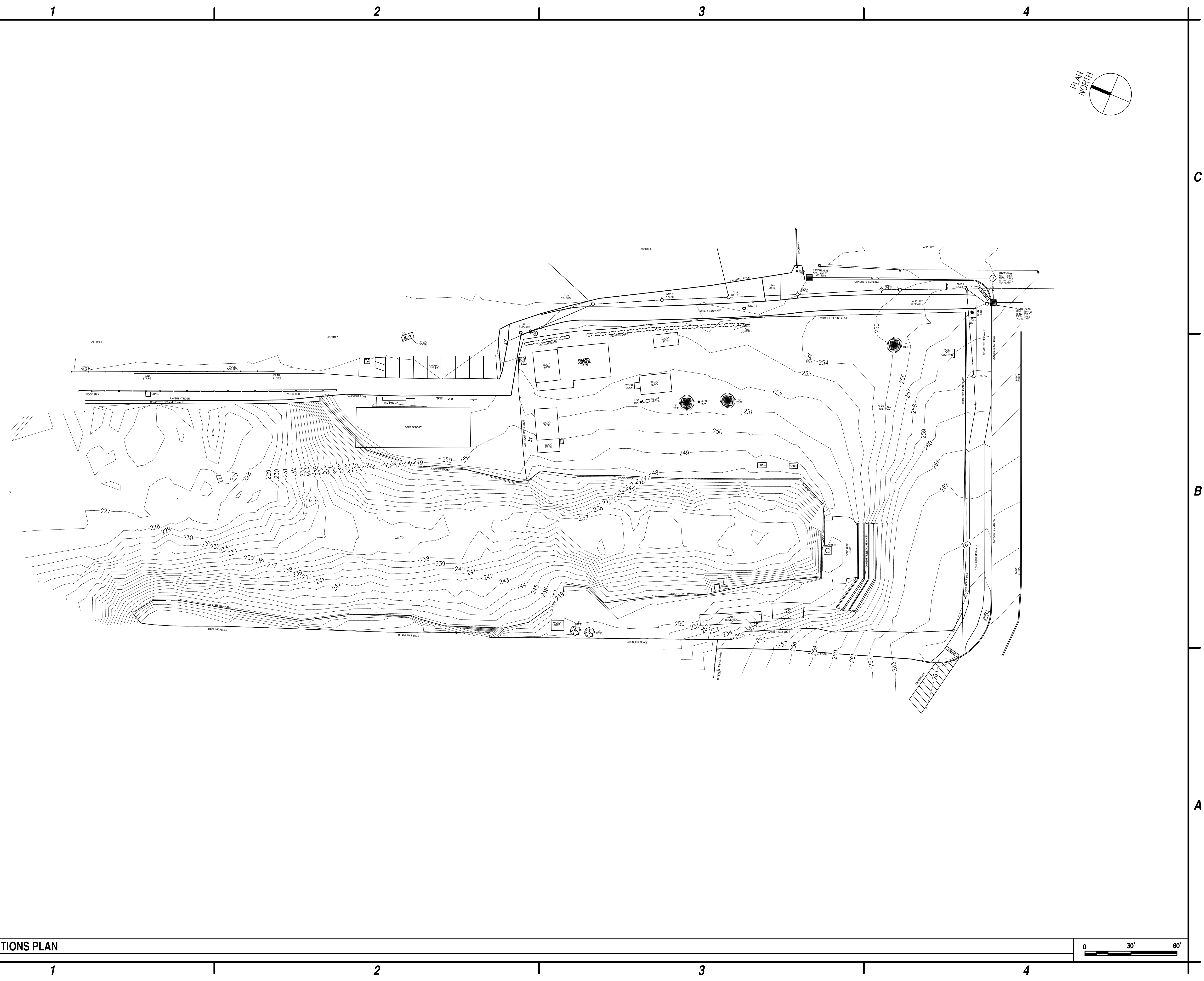

C&S Engineers, Inc.  
 499 Col. Eileen Collins Blvd.  
 Syracuse, New York 13212  
 Phone: 315-455-2000  
 Fax: 315-455-9667  
 www.cscos.com

**PRELIMINARY**  
 NOT FOR  
 CONSTRUCTION



**PORT OF OSWEGO AUTHORITY  
 3RED02  
 PORT AUTHORITY BOATING CTR  
 GOBLE DRY DOCK AND SHIP YARD  
 PERMITTING**

MARK	DATE	DESCRIPTION
REVISIONS		
PROJECT NO:		301030002
DATE:		DECEMBER 2020
DRAWN BY:		
DESIGNED BY:		
CHECKED BY:		

NO ALTERATION PERMITTED HEREON  
 EXCEPT AS PROVIDED UNDER SECTION  
 7209 SUBDIVISION 2 OF THE NEW YORK  
 EDUCATION LAW

**EXISTING  
 CONDITIONS  
 PLAN**

**C-101**

**A1** EXISTING CONDITIONS PLAN  
 SCALE: 1" = 30'-0"

